

Ref. : VG6400-004.pas

Rev. : A

Date : 28/09/09

Page : 1/2

KNIFE GATE VALVE STAINLESS STEEL BODY WITH MOUNTING PLATE FOR MOTORIZATION

VG6400-004



ROBINETTERIE INDUSTRIELLE ET ACCESSOIRES
INDUSTRIAL VALVES AND ACCESSORIES

APPLICATION

General use : Pulp production, water, water treatment, waste water, chemical industry (powdery or crystallizing products), wine-producing, pulverized products (cement work, pneumatic transport, stocking).

GENERAL CHARACTERISTICS

Range : from DN 50 to DN 600.
Function ON/OFF or regulation.
Wafer threaded mounting ISO PN10.
Unidirectional tightness, direction indication thanks to the arrow on the body.
Small retention zone: the gate is guided in the body and has little clearance.
Gland assembly: packing and O-ring (same materials as seat joint) to assure the elasticity and decrease the operating torque.
Small head loss. Possibility to regulate thick fluids with the adaptation of a diaphragm ring.
The range of knife gate valves is conceived to accept normally all the types of electric actuators thanks to its mounting flange of connecting according to the standard ISO 5210.

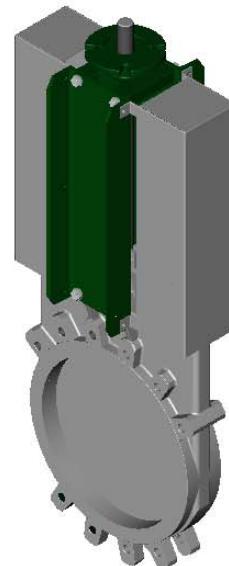

CONSTRUCTION

| | | | | |
|-------------|-------------|--------------------|--------------------------------------|--|
| 11 | 2 | Lateral protection | Stainless steel 304 | |
| 10 | 1 | O-ring | EPDM | |
| 9** | 1 | Support ring | Stainless steel X5CrNiMo 17-12-2 | DIN: X5CrNiMo18 10 ASTM: A 182 AISI 316 BS: 970 316 S16 |
| 8** | 1 | Gasket | EPDM | |
| 7 | 1 | Packing gland | Stainless steel | |
| 6 | 1 | Embase moteur | Painted steel | |
| 5* | 2 | Plaque support | Steel + Epoxy | |
| 4 | 1 | Vis de manœuvre | Stainless steel 13%Cr | |
| 3 | 1 | Knife | Stainless steel X5CrNiMo 17-12-2 | DIN: X5CrNiMo18 10 ASTM: A 182 AISI 316 BS: 1449-2 316 S16 |
| 2 | 2 | Packing | PTFE | |
| 1 | 1 | Body | Stainless steel GX5CrNiMo 19-11-2 | DIN: G-X6CrNiMo 18 10 ASTM: A 351 grade CF8M BS: 316 C16 |
| Pos. | Qty. | Description | Material | |

*Pre-shaped parts up to DN 300.

** Missing parts on metal / metal tightness.

DIMENSIONS

| DN | L | H | h | Ø T | Turns number for opening | C | D | Ø K | n | Ø M | ISO Mounting flange | Ø A | Ø B | Ø E | Ø F | Ø G | Ø N | Weight (kg) |
|-----|--------|-----|------|-----|--------------------------|-----|-----|-----|----|----------|---------------------|-----|-----|-----|-----|-----|-----|-------------|
| 50 | 2" | 40 | 305 | 36 | 13 | 124 | 83 | 125 | 4 | 4 x M16 | F07/F10 | 70 | 102 | 125 | 9 | 11 | 70 | 6 |
| 65 | 2 1/2" | 40 | 330 | 43 | 16 | 139 | 83 | 145 | 4 | 4 x M16 | | | | | | | | 8 |
| 80 | 3" | 50 | 355 | 40 | 20 | 154 | 83 | 160 | 8 | 4 x M16 | | | | | | | | 9 |
| 100 | 4" | 50 | 400 | 40 | 25 | 174 | 83 | 180 | 8 | 4 x M16 | F07/F10 | 70 | 102 | 125 | 9 | 11 | 70 | 10 |
| 125 | 5" | 50 | 438 | 38 | 31 | 189 | 93 | 210 | 8 | 4 x M16 | | | | | | | | 15 |
| 150 | 6" | 60 | 489 | 40 | 38 | 220 | 93 | 240 | 8 | 4 x M20 | | | | | | | | 19 |
| 200 | 8" | 60 | 608 | 50 | 40 | 275 | 108 | 295 | 8 | 4 x M20 | F10 | 102 | - | 125 | 12 | - | 70 | 33 |
| 250 | 10" | 70 | 700 | 48 | 50 | 326 | 108 | 350 | 12 | 8 x M20 | | | | | | | | 47 |
| 300 | 12" | 70 | 807 | 50 | 60 | 380 | 108 | 400 | 12 | 8 x M20 | | | | | | | | 58 |
| 350 | 14" | 96 | 910 | 45 | 58 | 450 | 290 | 460 | 16 | 10 x M20 | F10/F14 | 102 | 140 | 175 | 11 | 17 | 100 | 107 |
| 400 | 16" | 100 | 1020 | 53 | 67 | 510 | 290 | 515 | 16 | 10 x M24 | | | | | | | | 137 |
| 450 | 18" | 106 | 1115 | 63 | 75 | 564 | 290 | 565 | 20 | 14 x M24 | | | | | | | | 177 |
| 500 | 20" | 110 | 1225 | 53 | 83 | 630 | 290 | 620 | 20 | 14 x M24 | F10/F14 | 102 | 140 | 175 | 11 | 17 | 100 | 212 |
| 600 | 24" | 110 | 1429 | 50 | 100 | 726 | 290 | 725 | 20 | 14 x M27 | | | | | | | | 256 |

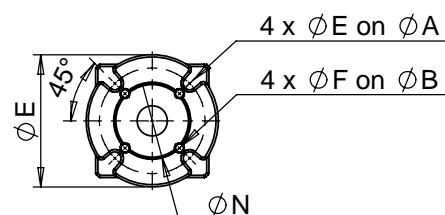
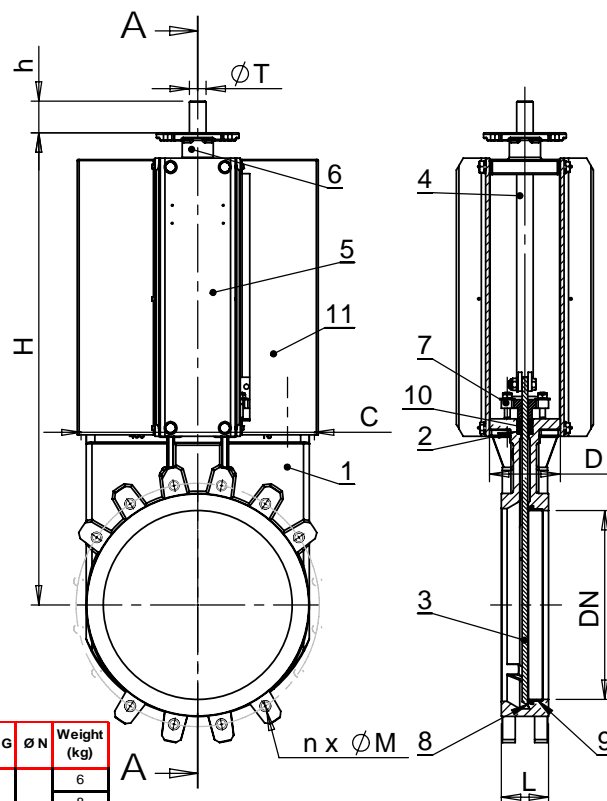

Ref. : VG6400-004.pas

Rev. : A

Date : 28/09/09

Page : 2/2

KNIFE GATE VALVE STAINLESS STEEL BODY WITH MOUNTING PLATE FOR MOTORIZATION

VG6400-004



ROBINETTERIE INDUSTRIELLE ET ACCESSOIRES
INDUSTRIAL VALVES AND ACCESSORIES

WORKING CONDITIONS

Maximum working pressure : DN 50-250 : 10 bar.
DN 300-450 : 7 bar.
DN 500-600 : 4 bar.

Maximum temperature : -20°C / +130°C (Standard tightness).

| Others materials on request (If marked) | Maximum temperature | |
|---|-------------------------|--------------------------|
| Metal / metal | T max : -10°C / +200°C. | <input type="checkbox"/> |
| Nitril | T max : -10°C / +80°C. | <input type="checkbox"/> |
| White EPDM | T max : -20°C / +130°C. | <input type="checkbox"/> |
| Silicone | T max : -20°C / +170°C. | <input type="checkbox"/> |
| FPM (Type Viton®) | T max : -10°C / +170°C. | <input type="checkbox"/> |
| PTFE | T max : +4°C / +170°C. | <input type="checkbox"/> |
| CSM (Type Hypalon®) | T max : +4°C / +80°C. | <input type="checkbox"/> |



Standard tightness



Tightness metal/metal

STANDARDS

Manufacture according to the requirements of the European directive 97/23/CE "Equipments under pressure" : category III modulate H.

Test procedures are established according to standards EN12266-1, DIN 3230, BS 5154 and ISO 5208.

Connections between flanges according to standard EN 1092-2 et DIN 2501 : ISO PN10.