

Ref. : BS 1153.pas

Rev. : Initial

Date : 03/09/2008

Page : 1/1

BALL VALVE WITH TAP AND DRAIN COCK

BS 1153



ROBINETTERIE INDUSTRIELLE ET ACCESSOIRES
INDUSTRIAL VALVES AND ACCESSORIES

APPLICATION

General use : for all kind of fluids.

GENERAL CHARACTERISTICS

From DN 3/8" to DN 2".
Full bore.
Sealing of the axis by packing flanged.
Flat handle.

CONSTRUCTION

Pos.	Qty.	Description	Material
6	1	Mobil body	Nickled brass
5	1	Packing flanged	PTFE
4	2	Seat	PTFE
3	1	Stem	Brass
2	1	Ball	Chromed brass
1	1	Body	Nickled brass

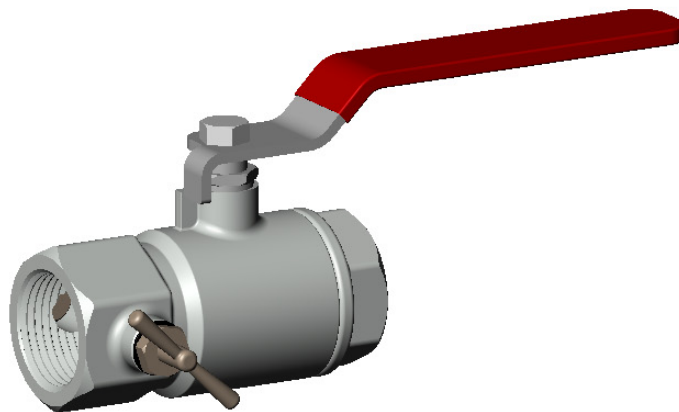

DIMENSIONS

DN		L	H	P	Weight (kg)
mm	inch				
15	1/2"	52,5	45,0	81,5	0,25
20	3/4"	59,5	48	104	0,33
25	1"	69,5	57	102	0,45
32	1"1/4	79,5	67,5	120	0,65
40	1"1/2	91,0	73,5	120	0,94
50	2"	106,5	87,5	142	1,47

WORKING CONDITIONS

PS max : DN 1/2" - 1" : 25 bar
 DN 1"1/4 - 1"1/2 : 20 bar
 DN 2" : 16 bar

T max : -20°C / +120°C

AGREEMENT AND TESTING

BSP threaded according to standard ISO 228-1.

