

Ref. : BS 6179.pas

Rev. : B

Date : 15/02/2007

Page : 1/1

# STAINLESS STEEL FULL BORE BALL VALVE PN64

## BS 6179



ROBINETTERIE INDUSTRIELLE ET ACCESSOIRES  
INDUSTRIAL VALVES AND ACCESSORIES

### APPLICATION

General uses : All chemical fluid, liquid vapor, gas, etc.

### GENERAL CHARACTERISTICS

Stainless steel body and ball - PTFE seat.  
BSP threaded ends - Full bore.  
Operating by stainless steel lever with locking device - PN 64.

### CONSTRUCTION

6	1	Mobil body	Stainless steel 316 GX5CrNiMo 19-11-2	DIN: G-X6CrNiMo18 10 ASTM: A 351 Grade CF8M BS: 1504 316 C16
5	1	Packing flanged	Stainless steel 316 GX5CrNiMo 19-11-2	DIN: G-X6CrNiMo18 10 ASTM: A 351 Grade CF8M BS: 1504 316 C16
4	2	Seat	PTFE	
3	1	Stem	Stainless steel 316 X5CrNiMo 17-12-2	DIN: X5CrNiMo18 10 ASTM: A 182 AISI 316 BS: 970 316 S16
2	1	Ball	Stainless steel 316 GX5CrNiMo 19-11-2	DIN: G-X6CrNiMo18 10 ASTM: A 351 Grade CF8M BS: 1504 316 C16
1	1	Body	Stainless steel 316 GX5CrNiMo 19-11-2	DIN: G-X6CrNiMo18 10 ASTM: A 351 Grade CF8M BS: 1504 316 C16
<b>Pos.</b>	<b>Qty.</b>	<b>Description</b>	<b>Material</b>	



### DIMENSIONS

DN		L	H	P	Weight (kg)
mm	inch				
8	1/4"	54	54	110	0,30
12	3/8"	54	55	110	0,30
15	1/2"	57	58	115	0,30
20	3/4"	68	61	115	0,48
25	1"	80	77	128	0,77
32	1" 1/4	91	81	128	1,20
40	1" 1/2	103	90	155	1,80
50	2"	124	108	155	2,70
65	2" 1/2	160	132	230	5,90
80	3"	185	145	230	7,70
100	4"	224,5	185	335	7,70

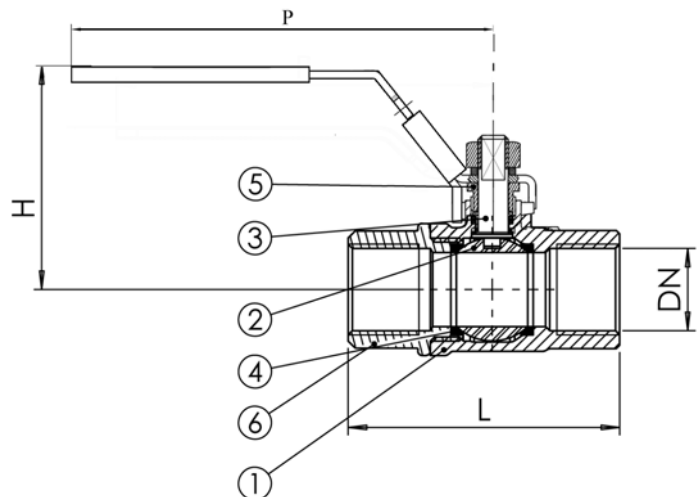

### WORKING CONDITIONS

Maximum working pressure : 64 bar.  
Temperature : + 100°C.  
Maximum temperature : + 150°C

Pressure test according to standards  
EN 12266-1, DIN 3230, BS 5154 and ISO 5208.  
Body : 96 bar  
Seat : 70 bar

### STANDARDS

BSP threaded according to standard ISO 228-1.

5, impasse Pascal - Z.I. - BP 177 - 69686 CHASSIEU Cedex - FRANCE  
Tél. +33 (0) 4 72 79 05 79 - Fax +33 (0) 4 78 90 19 19 / +33 (0) 4 72 79 05 70  
E-mail : tecofi@tecofi.fr - Service commercial / Sales dep. : sales@tecofi.fr - www.tecofi.fr